

Single Pole Terminal Board



ECI, ERMCO Components Inc.
1607 Industrial Road
Greeneville, TN 37745
Phone: (423) 638-2302
Toll Free: (877) 267-1855
Fax (423) 636-6492

Design Features

Single Pole Terminal Board is available in three (3) design types.

- 5/16"-18 x 1-1/4" hex head bolt and nut with integral lock washer.
- 5/16"-18 x 1" hex head bolt and nut with integral lock washer.
- 3/8"-16 x 1-1/4" hex head bolt and nut with integral lock washer.

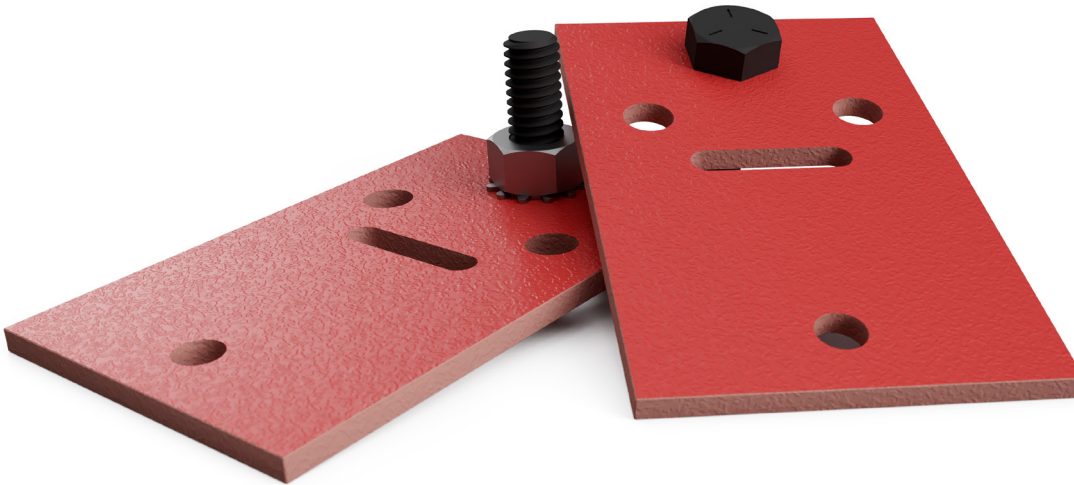

BEYOND THE STANDARD

ERMCO Components Incorporated introduces the Single Pole Terminal Board for use in single phase distribution transformers. The terminal block will mechanically and electrically secure the high voltage lead within the tank of the distribution transformer to;

- Help ensure lead routing for proper insulation between the high voltage and grounded objects.
- Hold the lead in place during manufacturing and when removing the tank cover to prevent damage within the coil should the high voltage lead be in tension.

Think of the ECI Terminal Board as an inexpensive insurance policy that helps prevent costly transformer damage and customer outages.

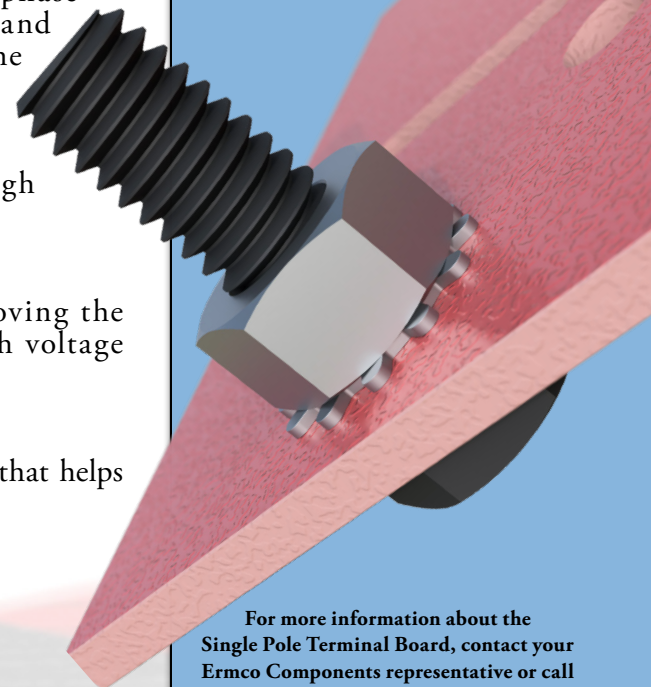

For more information about the Single Pole Terminal Board, contact your Ermco Components representative or call (877) 267-1855

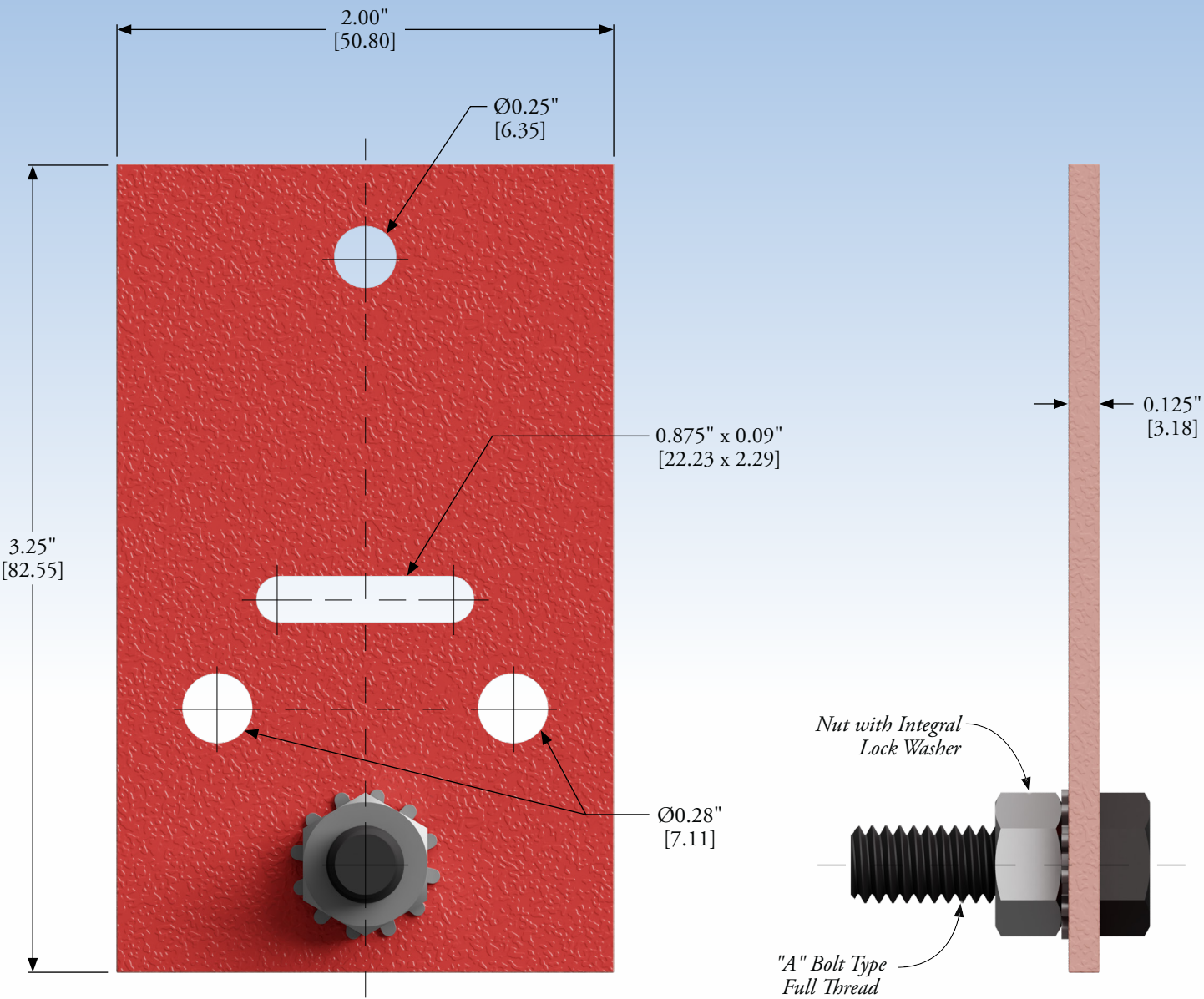

PRIMARY DIMENSIONS ARE INCHES
SECONDARY DIMENSIONS [] ARE MM

Note: Dimensions are given for reference only.

Ordering Information

| Catalog Number | "A" Bolt Type |
|----------------|-----------------|
| 7285ZA2299 | 5/16"-18 x 1-¼" |
| 7285ZA2399 | 5/16"-18 x 1" |
| 7285ZA2599 | 3/8"-16 x 1-¼" |