

*CLAMP (HV)*

UNLESS OTHERWISE SPECIFIED, TOLERANCES ARE

SURFACES ✓	2 PL DEC ± 0.02	3 PL DEC ± 0.005	ANGLES ± 5 DEG
---------------	--------------------	---------------------	-------------------

FIRST MADE FOR

*HV BUSHING WELL*

REVISIONS

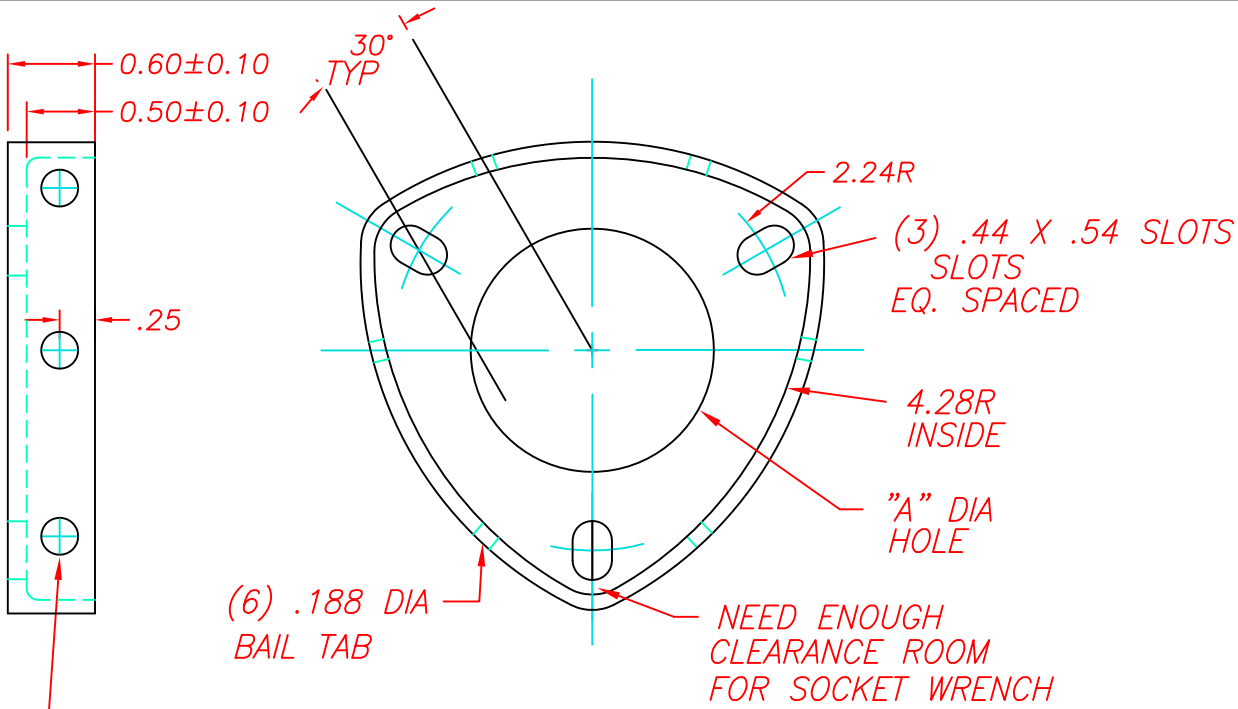

*(6) 0.200 HOLES MAY DEFORM TO 0.134 MIN WHEN FORMED*

CAT. NO. 9U09AAW267 P55 STEEL (ZINC ELECTROPLATE WITH YELLOW CHROMATE)  
B4A2F3 A=2.75±.02  
FIN F70B4B  
14 GAGE X 6.00 X 6.00 SQ.

CAT. NO. 9U09AAW268 P56 STN STL B7A65C3  
A=2.75 ±.02  
14 GAGE X 6.00 X 6.00 SQ.

9U09AAW268  
FLANGE 1921J000P56  
GASKET 7920K108P38  
LABEL 32A090001P74

9U09AAW267  
FLANGE 1921J000P55  
GASKET 7920K108P38  
LABEL 32A090001P73

11	S. STULPIN 04-JAN-01	CHG A DIM-WAS 2.72 (BOTH PARTS) ECN F642	CHG THICKNESS TO P55-WAS 13 GAGE ECN F660
12	S. STULPIN 20-FEB-01		
15	N. Adams 5/25/15	Updated P55 mat'l ECN B946	UPDATED TEMPLATE CHGD .188 HOLE TO .200, .140 MIN TO .134 ECN F 481
10	S. STULPIN 04-MAR-99		
13	S. STULPIN 06-MAR-01	CHG THICKNESS TO P56-WAS 13 GAGE ECN F663	UPDATE DISCRPTION
14	R. GILLAND 10/17/03		

*ECI-BTL*

PRINTS TO

MADE BY: *R. Wilkins 25-September-87*  
ISSUED BY: *Nicholas Adams 5/25/15*

APPROVAL

ECI

3101A 1921J000  
CONT ON SH SH 1